



BATIMENT : B NIVEAU : 2 TYPE : T2 LOT : B203

PLAN NOTAIRE

Juin 2023

SURFACES HABITABLES



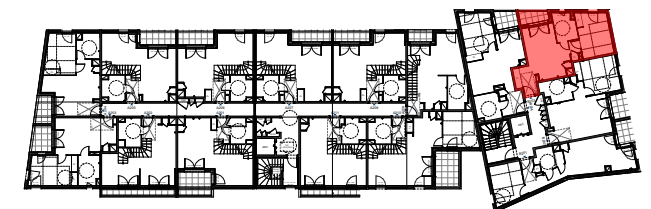



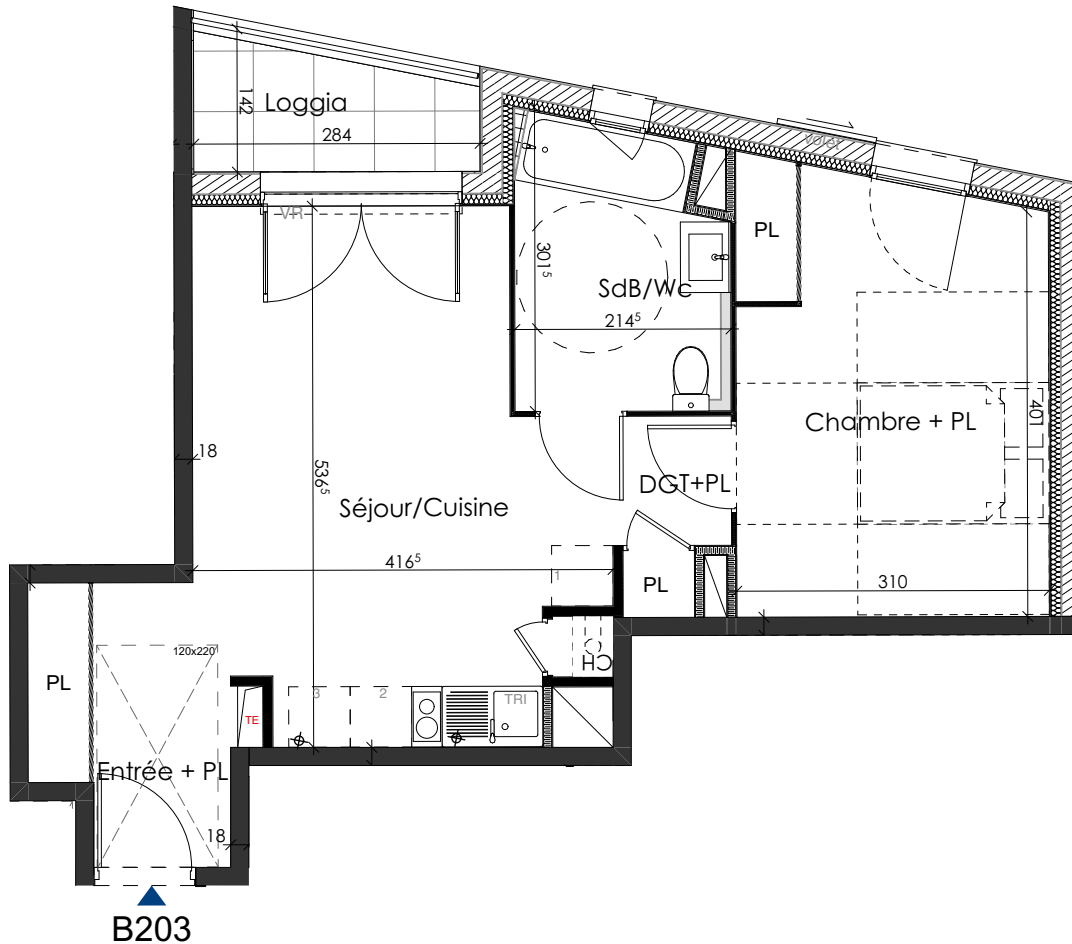

Séjour/Cuisine	19,75
Chambre + PL	13,35
SdB/Wc	5,72
Entrée + PL	3,86
DGT+PL	1,89
SURFACE TOTALE	44,57 m²
Loggia	3,62

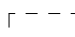
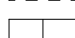

N









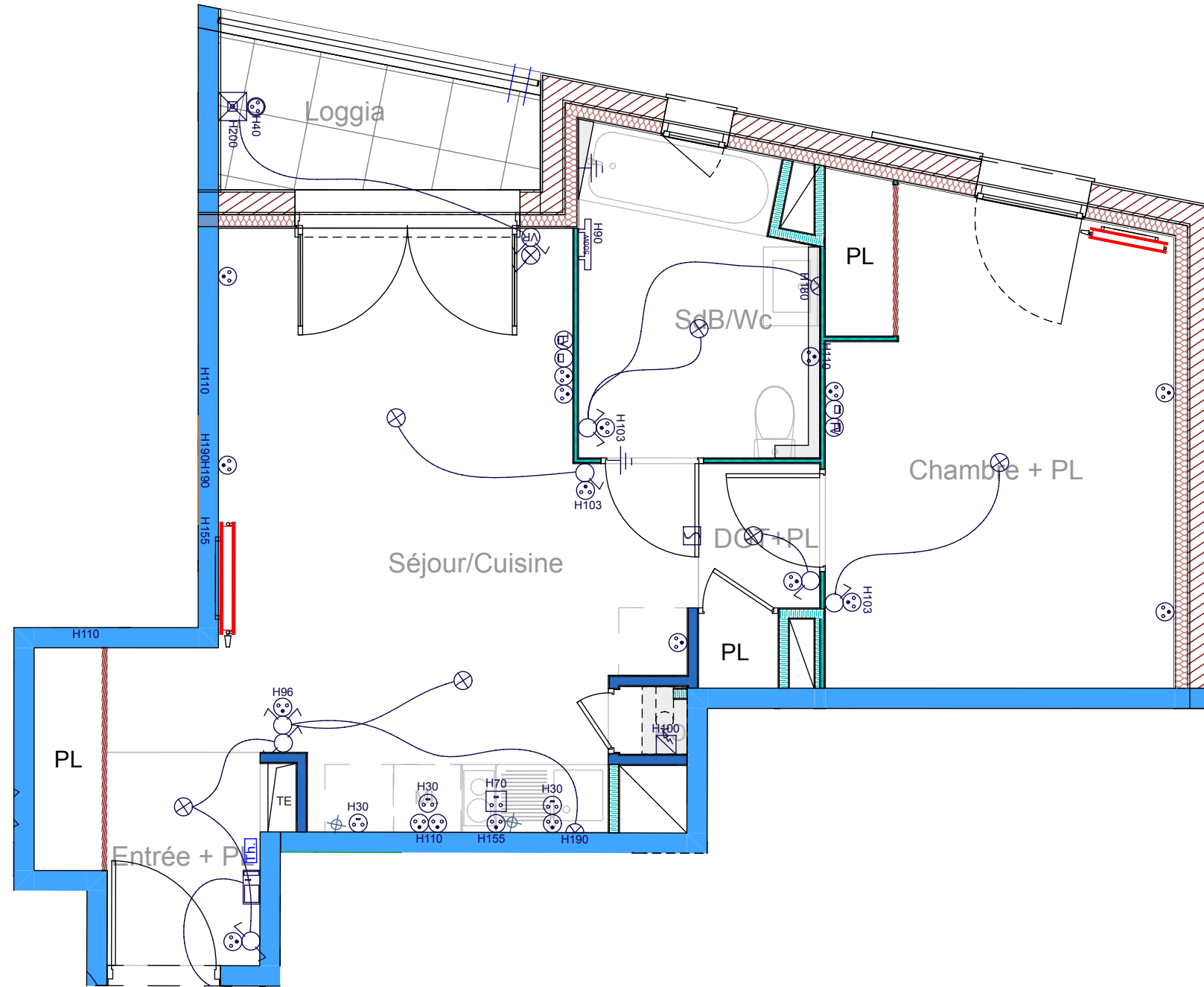







LÉGENDE

- VR** VOLET ROULANT
- CH** CHAUDIERE
- PL** PLACARD
-  **TE** TABLEAU ÉLECTRIQUE
-  MASQUETTE
-  FAUX - PLAFOND SOFFITE
-  NORMES PMR
-  TABLETTE
-  CLOISON DEMONTABLE
-  ÉVACUATION LL/LV
-  FENETRE sur allège vitrée
-  FENETRE sur allège pleine
-  PORTE-FENETRE

Implantation Electrique



-  Boîte de Raccordement
-  Simple Allumage
-  Simple Allumage à Voyant
-  Double Allumage
-  Va et Vient
-  Point Lumineux DCL (plafonnier)
-  Point Lumineux DCL (applique)
-  Lampe Ext. Busy
-  Portier Vidéo
-  DAAF
-  Prise 10/16A
-  Prise Spécialisée
-  Boîte 32A
-  Prise 10/16A Etanche
-  Prise RJ45