

# Clos Ambélia



BATIMENT: **BAT. B**  
 NIVEAU: **Niv 3**  
 TYPE: **T2**

LOT:  
**B303**

**PLAN NOTAIRE**

03/10/2024

## PLAN DE REPERAGE

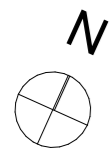
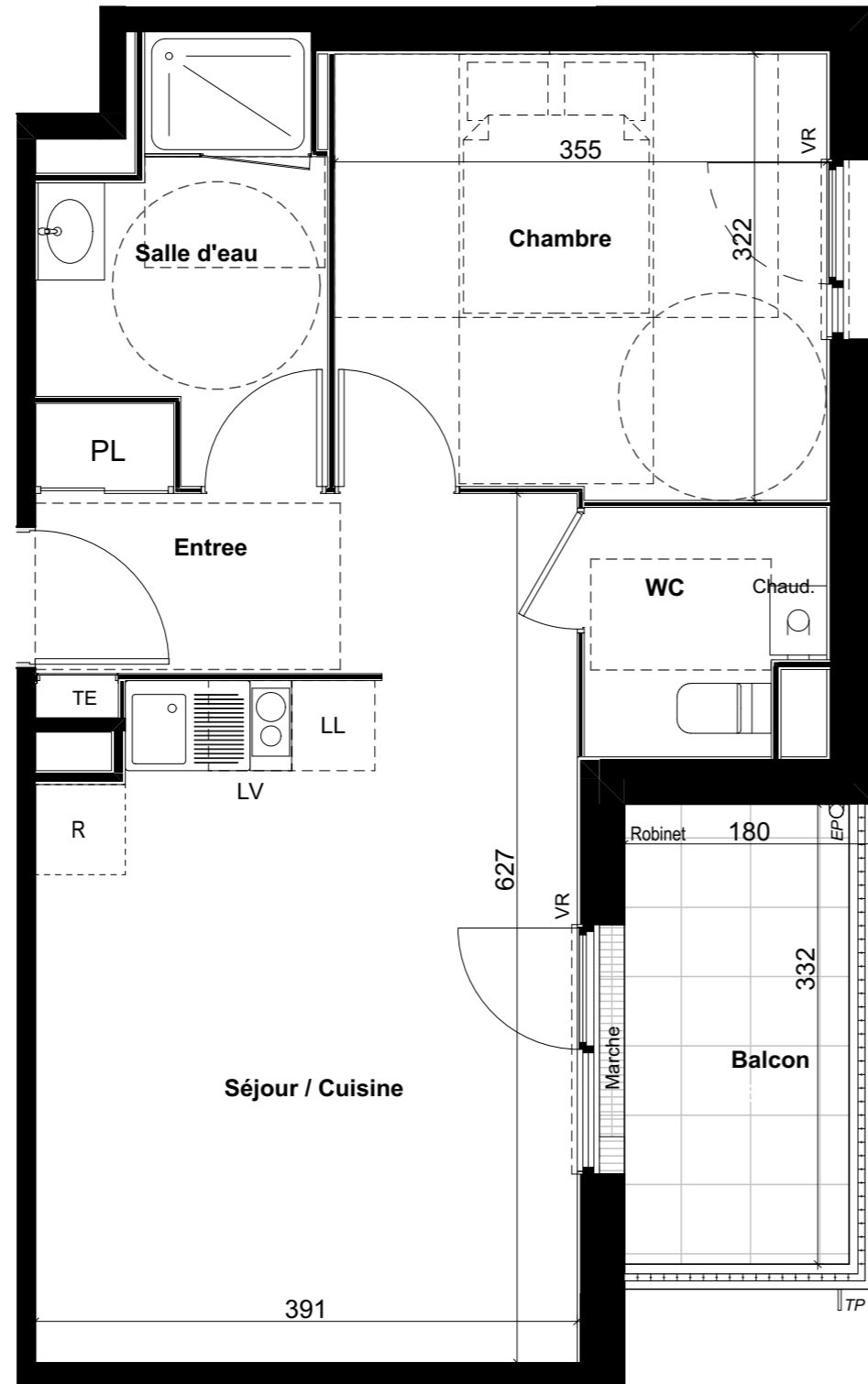
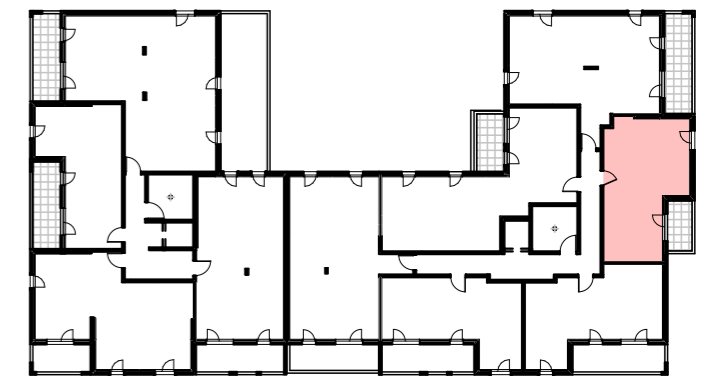

### LEGENDE

LV : Lave vaisselle  
 LL : Lave linge  
 R : Réfrigérateur  
 TE: Tableau électrique  
 VR: Volet Roulant  
 PL: Placard

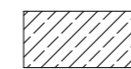

Faux -plafond  
 Soffite

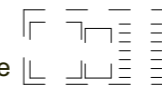

Evier  
 sur demande  
 pour les  
 T4



Chaudière à Gaz

### SURFACES HABITABLES (m²)

Entree Pl 3,39  
 Séjour / Cuisine 21,18  
 Chambre 11,25  
 Salle d'eau 4,19  
 WC 2,87  
**42,88 m²**

### SURFACES ANNEXES (m²)

Balcon 6,30  
**6,30 m²**

# IMPLANTATION DE L'APPAREILLAGE ELECTRIQUE

DATE : 12/02/2025

"CLOS AMBELIA"







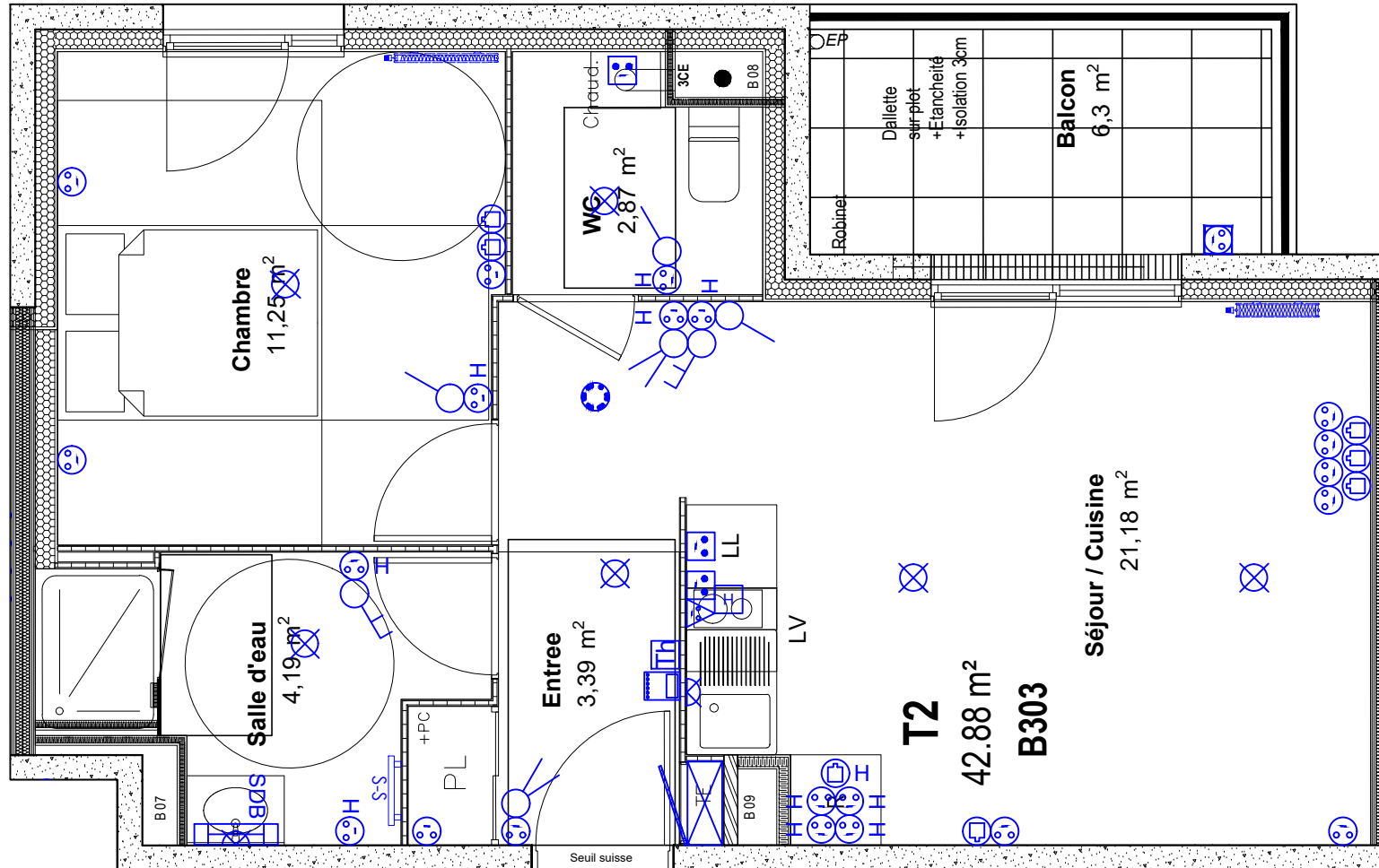













T2

B303

R+3



## LEGENDE

-  LUMINAIRE REGLETTE CUISINE
-  LUMINAIRE REGLETTE - SALLE DE BAIN
-  DOUILLE DCL
-  INTERRUPTEUR SIMPLE ALLUMAGE
-  INTERRUPTEUR SIMPLE ALLUMAGE - VOYANT
-  BOUTON POUSSOIR
-  INTERUPTEUR DOUBLE
-  INTERRUPTEUR VA ET VIENT
-  PRISE P+N+T 16A
-  PRISE P+N+T 16A H = 1.2m
-  PRISE 20A SPECIAL
-  PRISE P+N+T 16A ETANCHE
-  SORTIE DE FILS 2x32A+T
-  ETL LOGEMENT
-  ALIMENTATION HOTTE
-  COMBINE VIDEO INTERIEUR
-  DAAF
-  PRISE RJ45
-  RADIATEUR EAU CHAUDE
-  SECHE SERVIETTE ELEC
-  THERMOSTAT

CE PLAN EST SUSCEPTIBLE D'ETRE LEGEREMENT MODIFIE EN FONCTION DES NECESSITES TECHNIQUES DE LA REALISATION EN CE QUI CONCERNE LES DIMENSIONS LIBRES, LES EQUIPEMENTS ET LE POSITIONNEMENT DES APPAREILLAGES ELECTRIQUE. LES RETOMBES, SOFFITES, ENCOFFREMENTS, FAUX PLAFONDS, CANALISATIONS NE SONT PAS FIGURES ET NE POURRONT FONDER AUCUNE RECLAMATION EN CAS DE PRESENCE.



URBAT  
Immeuble OXYGENE  
1401 Avenue du Mondial 98  
34965 Montpellier Cedex 2