

Clos Ambélia



BATIMENT: **BAT. A**
 NIVEAU: **Niv 2**
 TYPE: **T2**

LOT:
A203

PLAN NOTAIRE

15/10/2024

PLAN DE REPERAGE

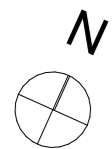
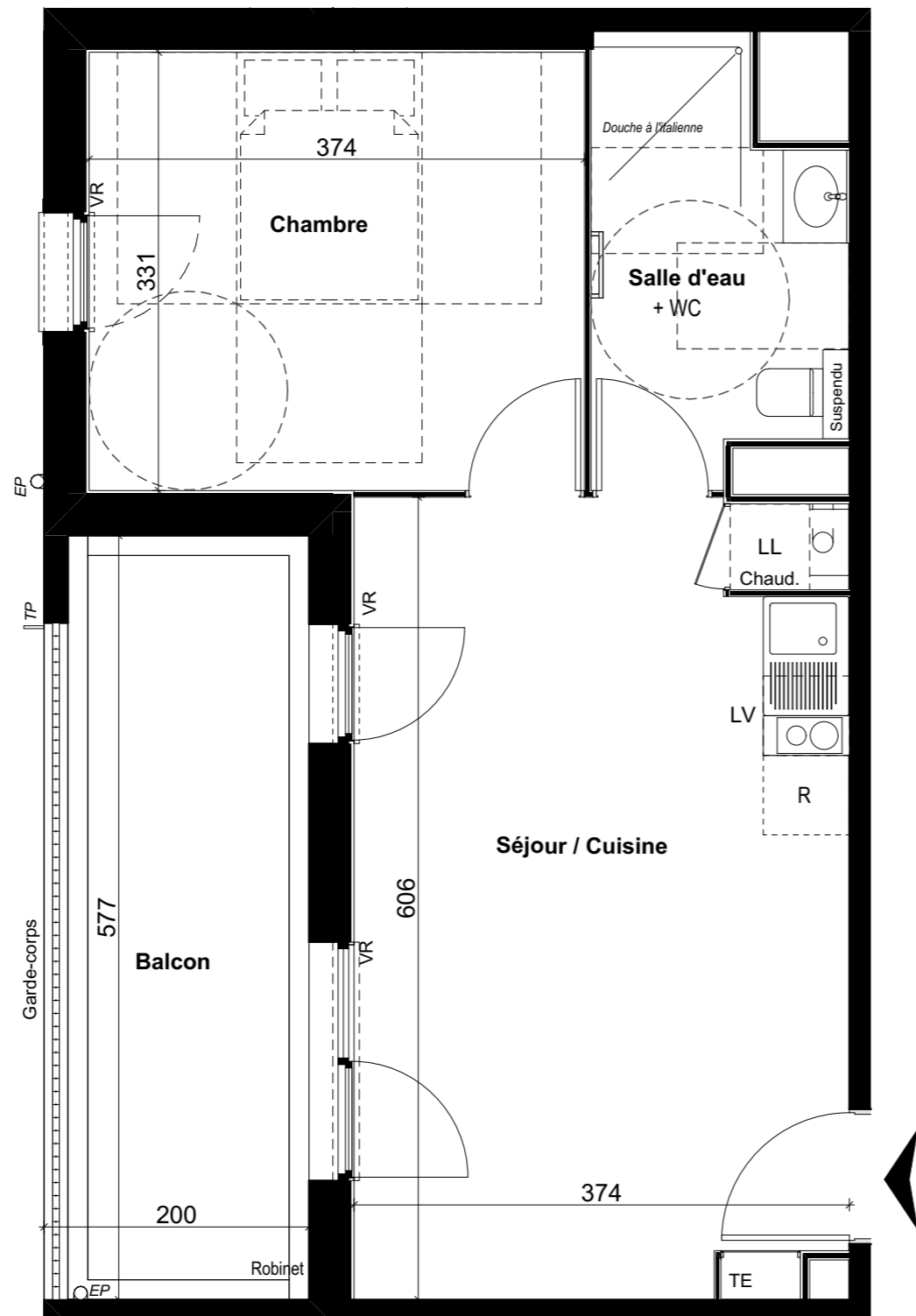
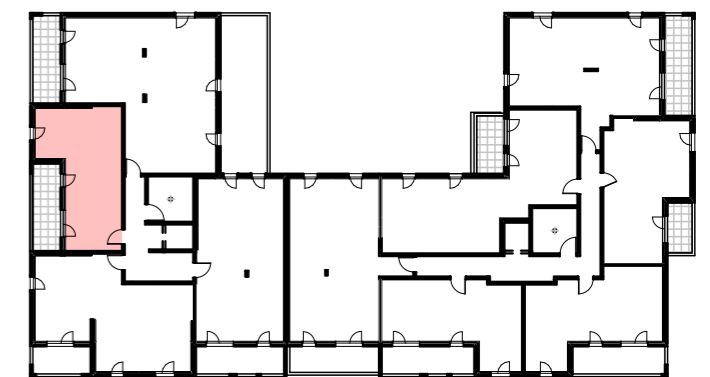

LEGENDE

- LV : Lave vaisselle
- LL : Lave linge
- R : Réfrigérateur
- TE: Tableau électrique
- VR: Volet Roulant
- PL: Placard
-  Faux -plafond Soffite
-  Evier sur demande pour les T4
-  Chaudière à Gaz

SURFACES HABITABLES (m ²)		SURFACES ANNEXES (m ²)	
Séjour / Cuisine	22,19	Balcon	11,42
Chambre	12,38		11,42 m²
Salle d'eau + WC	5,72		
	40,29 m²		

IMPLANTATION DE L'APPAREILLAGE ELECTRIQUE

DATE : 20/11/2024

"CLOS AMBELIA"







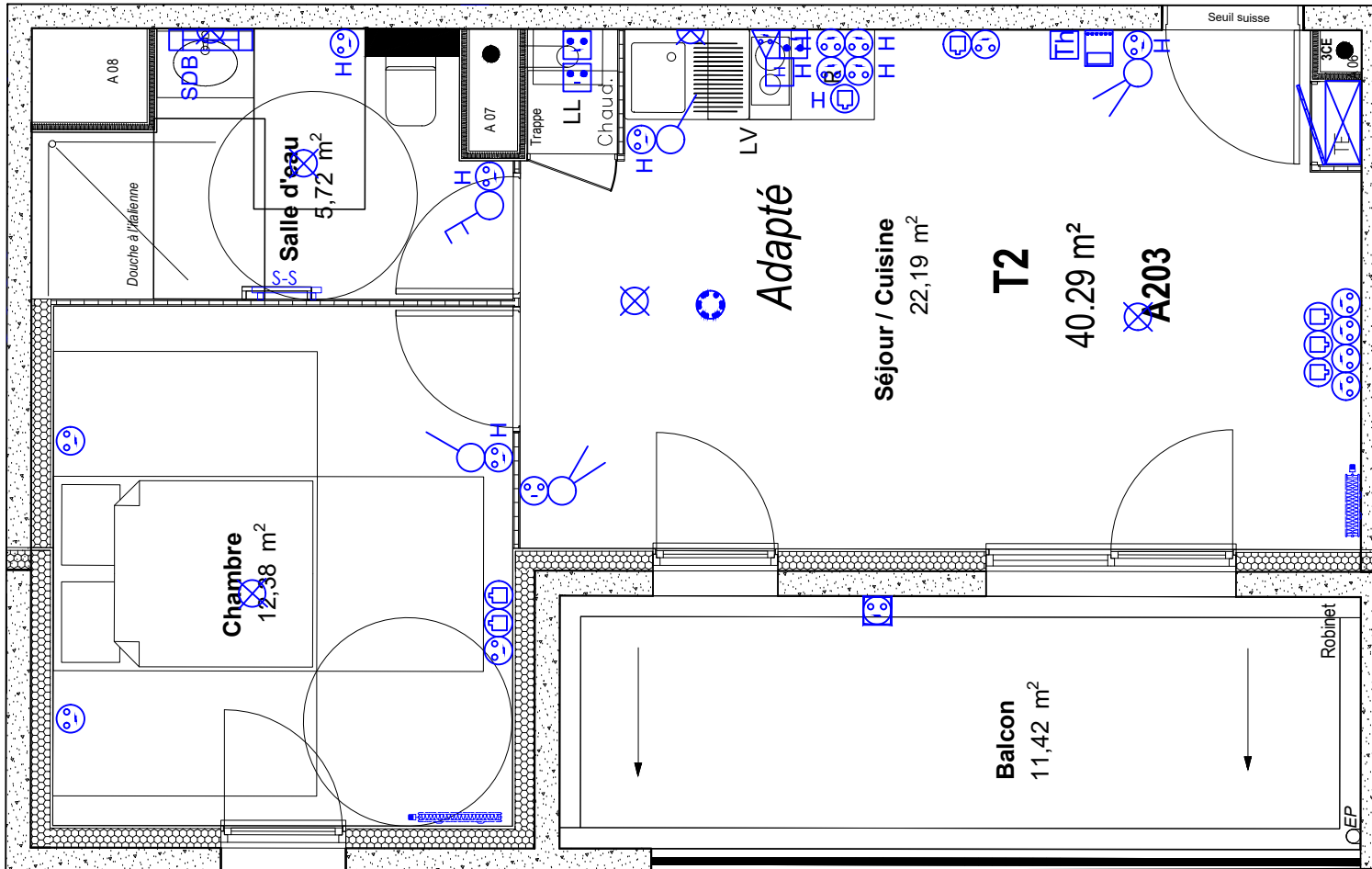













T2

A203

R+2



LEGENDE

-  LUMINAIRE REGLETTE CUISINE
-  LUMINAIRE REGLETTE - SALLE DE BAIN
-  DOUILLE DCL
-  INTERRUPTEUR SIMPLE ALLUMAGE
-  INTERRUPTEUR SIMPLE ALLUMAGE - VOYANT
-  BOUTON POUSSOIR
-  INTERUPTEUR DOUBLE
-  INTERRUPTEUR VA ET VIENT
-  PRISE P+N+T 16A
-  PRISE P+N+T 16A H = 1.2m
-  PRISE 20A SPECIAL
-  PRISE P+N+T 16A ETANCHE
-  SORTIE DE FILS 2x32A+T
-  ETL LOGEMENT
-  ALIMANTATION HOTTE
-  COMBINE VIDEO INTERIEUR
-  DAAF
-  PRISE RJ45
-  RADIATEUR EAU CHAUDE
-  SECHE SERVIETTE ELEC
-  THERMOSTAT

CE PLAN EST SUSCEPTIBLE D'ETRE LEGEREMENT MODIFIE EN FONCTION DES NECESSITES TECHNIQUES DE LA REALISATION EN CE QUI CONCERNE LES DIMENSIONS LIBRES, LES EQUIPEMENTS ET LE POSITIONNEMENT DES APPAREILLAGES ELECTRIQUE. LES RETOMBES, SOFFITES, ENCOFFREMENTS, FAUX PLAFONDS, CANALISATIONS NE SONT PAS FIGURES ET NE POURRONT FONDER AUCUNE RECLAMATION EN CAS DE PRESENCE.



URBAT
Immeuble OXYGENE
1401 Avenue du Mondial 98
34965 Montpellier Cedex 2